

Assembly Instructions

Air Barrel



Thank you for investing in the Tumbl Trak Air Barrel.

After opening the box, please check the parts list to make sure all pieces have arrived in good condition. If you have any questions during this assembly process, please call customer service at 44 (0)2921 167 949.

A.



B.



C.



*Remove the Green ring before using the adapter.



Tumbl Trak
Train Smart



WARNING

- Serious injury (including permanent paralysis or death) could result from any activity involving motion, rotation or height.
- All users of this equipment assume this risk of serious injury.
- Mats and pits cannot and do not eliminate hazards.

Safety Instructions

ALWAYS:

1. Consult an instructor prior to use.
2. Use equipment **ONLY** under the supervision of trained and qualified instructors.
3. Use equipment with trained spotters and the proper spotting equipment.
4. Check equipment before use for proper positioning; equipment can move during use.
5. Follow a progressive learning pattern. Assure basic skills are achieved before attempting more advanced skills.
6. Use equipment **ONLY** when all hard exposed surfaces are protected with proper mats.
7. Assure that all inflatable equipment has sufficient air pressure to avoid injury.

DO NOT use the apparatus with damaged, worn or missing parts.

DO NOT allow more than one person at a time to use the equipment.

Parts List

Parts:

- A. Air Barrel
- B. Hand Pump
- C. Adapter

STEP 1 – After unboxing and rolling out your Air Barrel, locate the valve. Remove the dust cover by turning counter clockwise to reveal the valve pin.

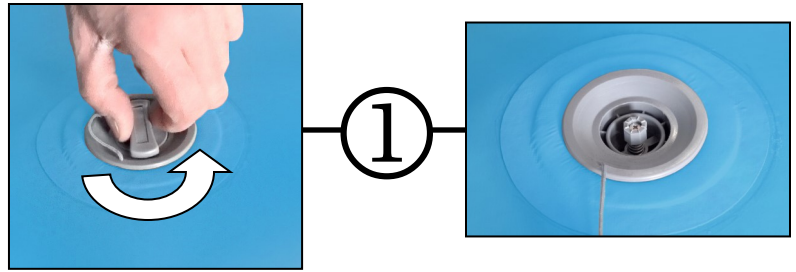

②



STEP 2 – Before inflating make sure the valve is closed. To close valve push the pin down and turn a quarter of the way around. The pin should be slightly taller than the rim of the valve. Connect the adapter to the hand pump tube after removing the Green ring (leaving the yellow and black ring). Insert the adapter into the valve by pushing down and turning clockwise to lock in place. Start manually inflating the Air Barrel. Put the dust cover on once inflated.



③

STEP 3 – To open the valve and deflate the Air Barrel push the pin down and turn a quarter of the way around. The pin should sit just below the valve rim.



④

STEP 4 — Make sure the dust cover remains on the valve both inflated and deflated to prevent particles from entering the valve.

